



TOP DOWN

Motorized Roller Shade System

Installation Manual v1.0



Assembly Parts:

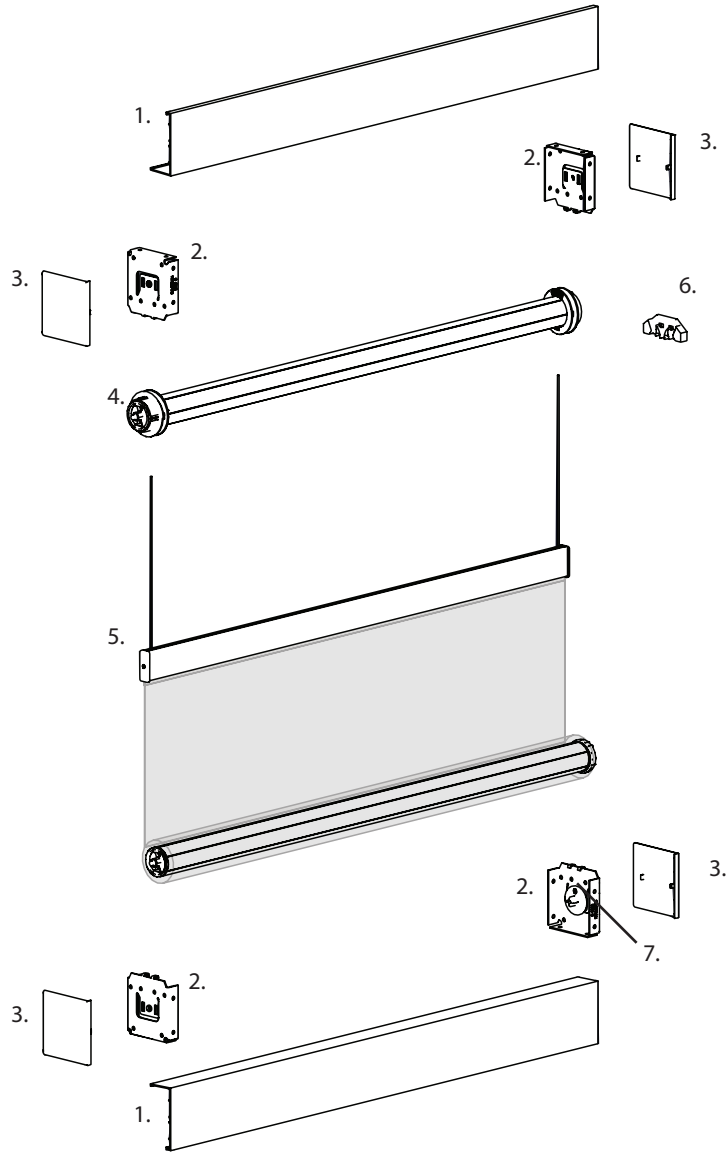

1. Fascia
2. Fascia Bracket
3. Bracket Cover
4. Top Tube & Control Assembly
5. Bottom Tube & Rail Assembly
6. Chain Diverter (3" Fascia Bracket with clutch control only)
7. Bracket Adapter

Bracket Installation:

STEP 1. - ATTACH BRACKETS TO WALL/CEILING

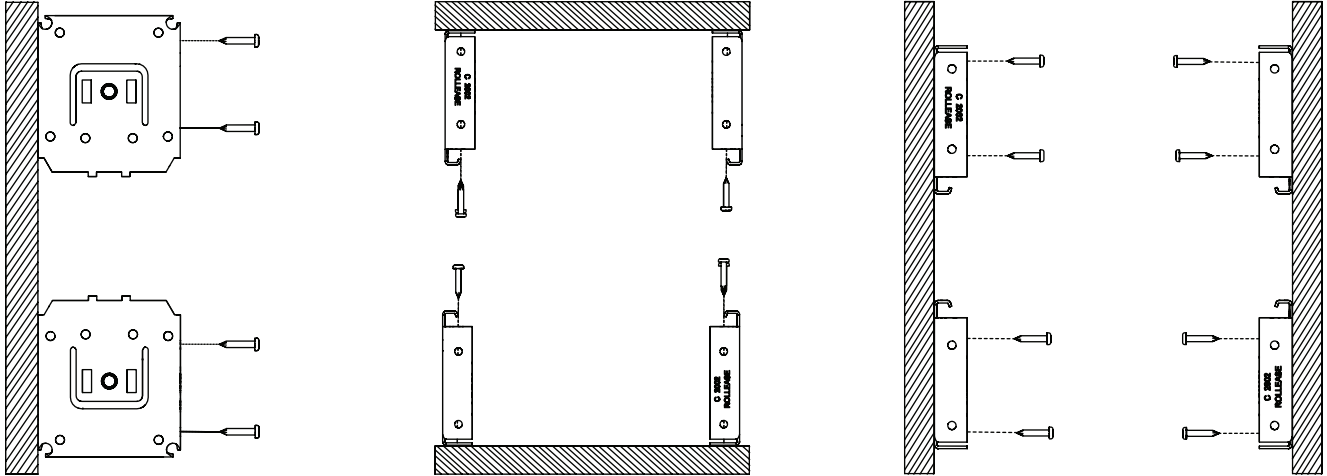

STEP 2. - ENSURE STRAIGHT ALIGNMENT

Ensure brackets are in line.

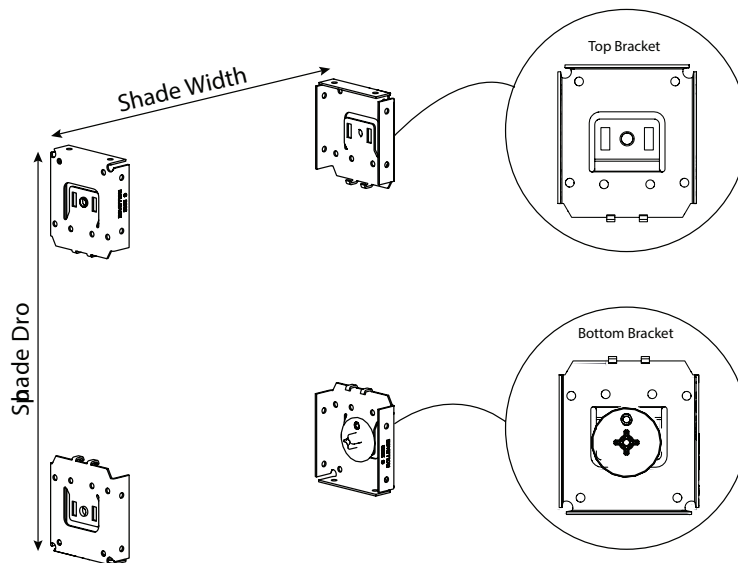
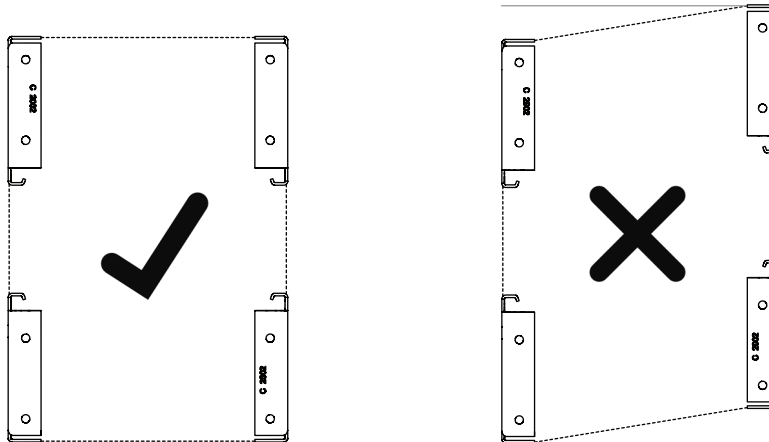

Top Assembly:

STEP 1. - LOCK CONTROL HOOKS TO THE BRACKET

Ensure that the control hooks are locked to the bracket.

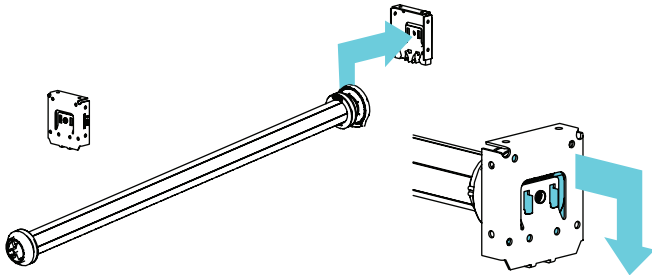

STEP 2. - SWING PIN END INTO THE BRACKET

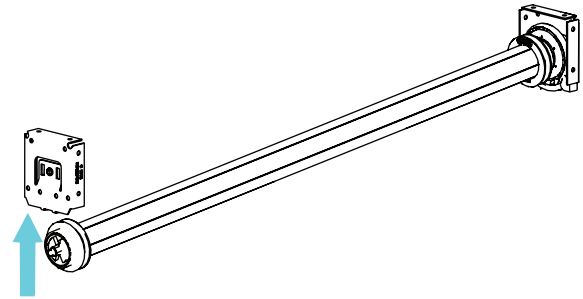

Bottom Assembly:

STEP 1. - PRE-TENSION BOOSTER

Use booster pre-tension tool to pre-tension the booster with clockwise rotations.

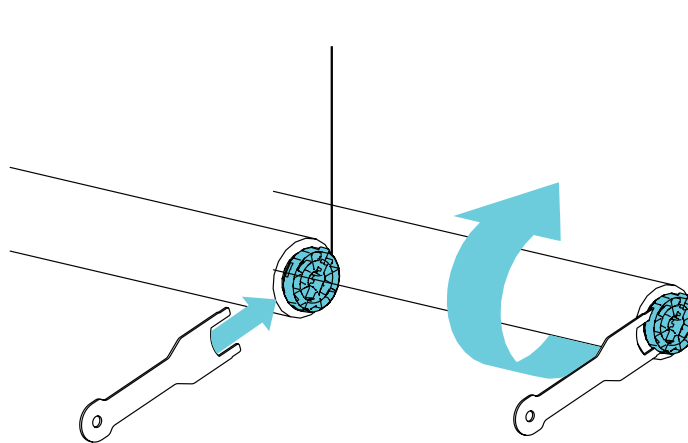

STEP 2. - PRE-TENSION BOOSTER

Use booster pre-tension tool to pre-tension the booster with clockwise rotations. Wrench is used to keep tension in the spring while installing the bottom assembly to brackets.

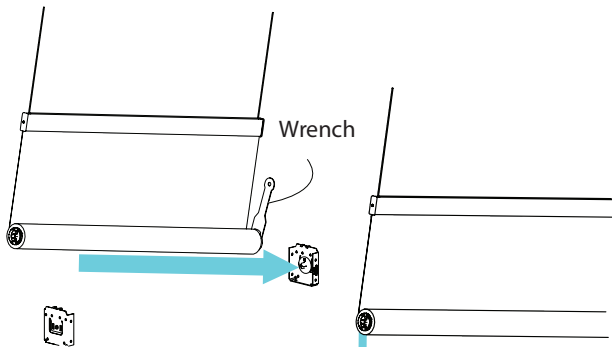

STEP 3. - ATTACH CORD

Attach cord to the spools by tying a knot.

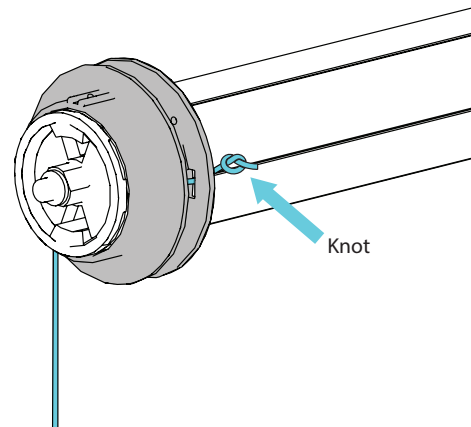

STEP 4. - ADJUST CORD GUIDES

Adjust the cord guides so that the cords are vertical.

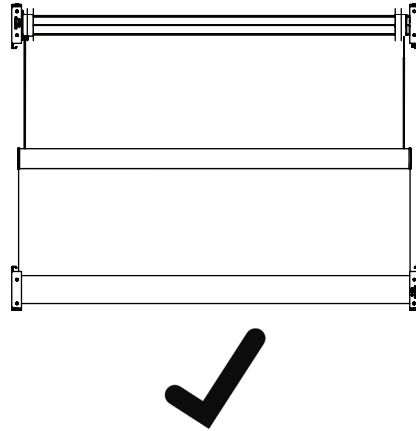
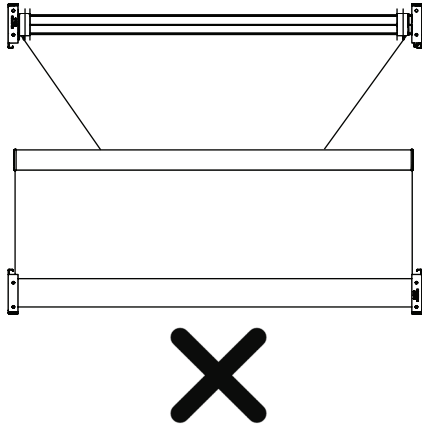

STEP 4. - ATTACH RAIL SEAL

Cut rail seal in two places to suit cord location.

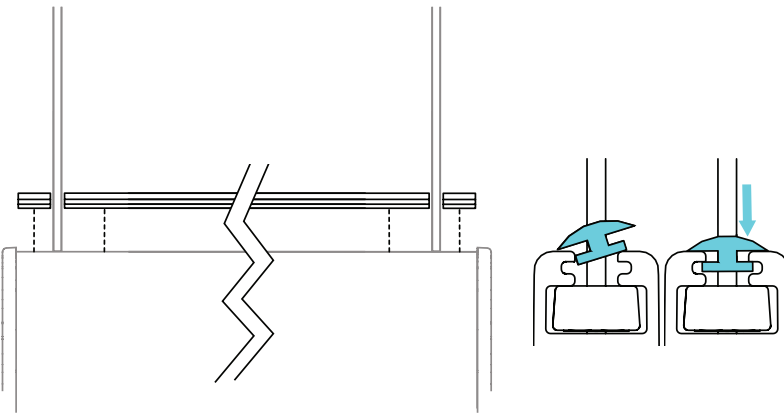

Fascia Installation:

Attach fascia and bracket covers.

TOP FASCIA

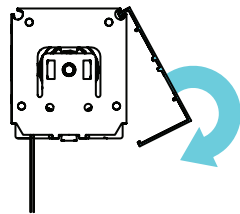

BOTTOM FASCIA

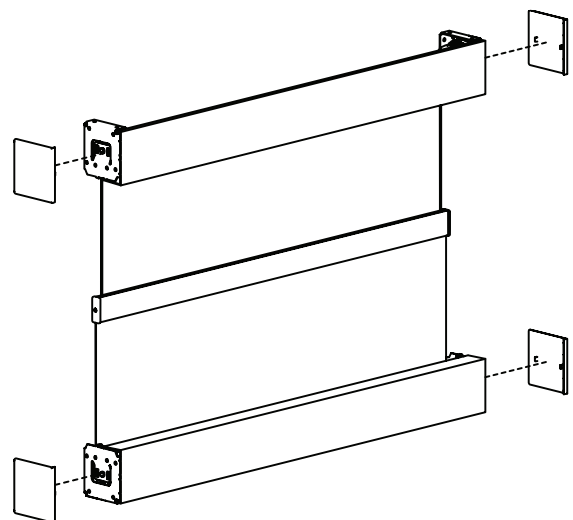
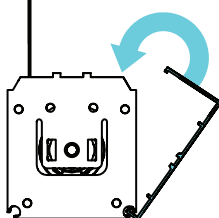

Booster pre-turns:

	TURNS		
	ft	m	
D R O P		0.4	37
	2	0.6	35
		0.8	33
	3	1.0	32
		1.2	30
	4	1.4	29
		1.6	28
	6	1.8	26
		2.0	25
	8	2.2	24
		2.4	22
	10	2.6	21
	2.8	20	
12	3.0	19	

Above chart indicates the maximum number of booster pre-turns for specified height. Please review below troubleshooting section if the shade doesn't operate properly.

Troubleshooting:

PROBLEM	CAUSE	SOLUTION
1. Fabric roll turns slowly.	Low bottom booster pre-turns	Increase bottom booster pre-turns 1. Lower shade 2. Use pre-tension tool to lock booster control 3. Remove bottom tube 4. Apply additional pre-turns 5. Re-install bottom tube
2. Heavy when raising the weight bar	Bottom booster pre-turns too high	1. Lower shade 2. Use pre-tension tool to lock booster control 3. Remove bottom tube 4. Remove pre-turns 5. Re-install bottom tube
3. Poor visual appearance of fabric	Shade tension is too low	Increase bottom booster pre-turns 1. Lower shade 2. Use pre-tension tool to lock booster control 3. Remove bottom tube 4. Apply additional pre-turns 5. Re-install bottom tube
	Weight bar is sagging	Move spools and cord guides inwards (max 30% of blind width from edge)